Volume 6

Appendix D

Selected Site History Information

Environment Protection Licence

Licence - 11700

**Licence Details**

Number:	11700
Anniversary Date:	25-November
Review Due Date:	23-Jan-2011

Licensee

ABSOLUTE TYRE & RUBBER RECYCLING PTY LTD (C/- SCOTT DARREN PASCOE-LIQUIDATOR)
LEVEL 24, 264 GEORGE STREET
SYDNEY NSW 2000

Licence Type

Premises

Premises

ABSOLUTE TYRE & RUBBER RECYCLING PTY LTD
62 LEVEL CROSSING ROAD
VINEYARD NSW 2765

Scheduled Activity

Waste Facilities - tyres
Waste Facilities - env sens landfill

Fee Based Activity

Fee Based Activity	Scale
Used Tyre Processing or Disposal (76)	0 - All
Environmentally Sensitive or Inappropriate Landfilling (81)	0 - All

Region

Waste Operations
59-61 Goulburn Street
SYDNEY NSW 2000
Phone: 02 9995 5000
Fax: 02 9995 5999

PO Box A290 SYDNEY SOUTH
NSW 1232

Environment Protection Licence

Licence - 11700



INFORMATION ABOUT THIS LICENCE.....	4
Dictionary.....	4
Responsibilities of licensee.....	4
Variation of licence conditions	4
Duration of licence	4
Licence review	4
Fees and annual return to be sent to the EPA.....	4
Transfer of licence	5
Public register and access to monitoring data.....	5
1 ADMINISTRATIVE CONDITIONS	5
A1 What the licence authorises and regulates	5
A2 Premises to which this licence applies.....	7
A3 Other activities	7
A4 Information supplied to the EPA.....	7
2 DISCHARGES TO AIR AND WATER AND APPLICATIONS TO LAND.....	7
P1 Location of monitoring/discharge points and areas.....	7
3 LIMIT CONDITIONS	8
L1 Pollution of waters.....	8
L2 Load limits.....	8
L3 Concentration limits.....	8
L4 Volume and mass limits	9
L5 Waste	9
L6 Noise Limits.....	9
L7 Hours of Operation.....	9
4 OPERATING CONDITIONS.....	10
O1 Activities must be carried out in a competent manner.....	10
O2 Maintenance of plant and equipment	10
O3 Tyre Storage.....	10
O4 Dust Control	10
O5 Management of the cells	10
O6 Site Management	11
5 MONITORING AND RECORDING CONDITIONS	11
M1 Monitoring records.....	11
M2 Requirement to monitor concentration of pollutants discharged	11
M3 Testing methods - concentration limits.....	12
M4 Recording of pollution complaints	12
M5 Telephone complaints line.....	13
M6 Requirement to monitor volume or mass	13
6 REPORTING CONDITIONS	13

Environment Protection Licence

Licence - 11700

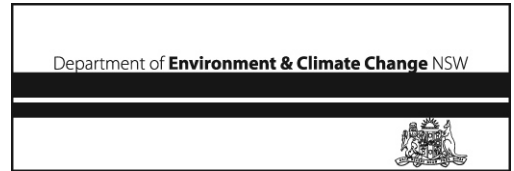

R1	Annual return documents	13
R2	Notification of environmental harm.....	15
R3	Written report	15
R4	Recording of fires	16
GENERAL CONDITIONS.....		16
G1	Copy of licence kept at the premises	16
POLLUTION STUDIES AND REDUCTION PROGRAMS		16
U1	Submission of a Closure Plan	16
SPECIAL CONDITIONS.....		17
E1	Financial Assurance.....	17
DICTIONARY		17
	General Dictionary	17



Information about this licence

Dictionary

A definition of terms used in the licence can be found in the dictionary at the end of this licence.

Responsibilities of licensee

Separate to the requirements of this licence, general obligations of licensees are set out in the Protection of the Environment Operations Act 1997 ("the Act") and the Regulations made under the Act. These include obligations to:

- ensure persons associated with you comply with this licence, as set out in section 64 of the Act;
- control the pollution of waters and the pollution of air (see for example sections 120 - 132 of the Act); and
- report incidents causing or threatening material environmental harm to the environment, as set out in Part 5.7 of the Act.

Variation of licence conditions

The licence holder can apply to vary the conditions of this licence. An application form for this purpose is available from the EPA.

The EPA may also vary the conditions of the licence at any time by written notice without an application being made.

Where a licence has been granted in relation to development which was assessed under the Environmental Planning and Assessment Act 1979 in accordance with the procedures applying to integrated development, the EPA may not impose conditions which are inconsistent with the development consent conditions until the licence is first reviewed under Part 3.6 of the Act.

Duration of licence

This licence will remain in force until the licence is surrendered by the licence holder or until it is suspended or revoked by the EPA or the Minister. A licence may only be surrendered with the written approval of the EPA.

Licence review

The Act requires that the EPA review your licence at least every 5 years after the issue of the licence, as set out in Part 3.6 and Schedule 5 of the Act. You will receive advance notice of the licence review.

Fees and annual return to be sent to the EPA

For each licence fee period you must pay:

- an administrative fee; and
- a load-based fee (if applicable).

The EPA publication "A Guide to Licensing" contains information about how to calculate your licence fees.

Environment Protection Licence

Licence - 11700



The licence requires that an Annual Return, comprising a Statement of Compliance and a summary of any monitoring required by the licence (including the recording of complaints), be submitted to the EPA. The Annual Return must be submitted within 60 days after the end of each reporting period. See condition R1 regarding the Annual Return reporting requirements.

Usually the licence fee period is the same as the reporting period.

Transfer of licence

The licence holder can apply to transfer the licence to another person. An application form for this purpose is available from the EPA.

Public register and access to monitoring data

Part 9.5 of the Act requires the EPA to keep a public register of details and decisions of the EPA in relation to, for example:

- licence applications;
- licence conditions and variations;
- statements of compliance;
- load based licensing information; and
- load reduction agreements.

Under s320 of the Act application can be made to the EPA for access to monitoring data which has been submitted to the EPA by licensees.

This licence is issued to:

**ABSOLUTE TYRE & RUBBER RECYCLING PTY LTD
(C/- SCOTT DARREN PASCOE-LIQUIDATOR)
LEVEL 24, 264 GEORGE STREET
SYDNEY NSW 2000**

subject to the conditions which follow.

1 Administrative conditions

A1 What the licence authorises and regulates

A1.1 Not applicable.

A1.2 This licence authorises the carrying out of the scheduled activities listed below at the premises specified in A2. The activities are listed according to their scheduled activity classification, fee-

Environment Protection Licence



Licence - 11700

based activity classification and the scale of the operation.

Unless otherwise further restricted by a condition of this licence, the scale at which the activity is carried out must not exceed the maximum scale specified in this condition.

Scheduled Activity
Waste Facilities - tyres
Waste Facilities - env sens landfill

Fee Based Activity	Scale
Used Tyre Processing or Disposal (76)	0 - All
Environmentally Sensitive or Inappropriate Landfilling (81)	0 - All

A1.3 Not applicable.

Environment Protection Licence

Licence - 11700



A2 Premises to which this licence applies

A2.1 The licence applies to the following premises:

Premises Details
ABSOLUTE TYRE & RUBBER RECYCLING PTY LTD
62 LEVEL CROSSING ROAD
VINEYARD
NSW
2765
PORTION 45, LOT 2 DP 74436 & LOTS 1-2 DP123962

A3 Other activities

A3.1 Not applicable.

A4 Information supplied to the EPA

A4.1 Works and activities must be carried out in accordance with the proposal contained in the licence application, except as expressly provided by a condition of this licence.

In this condition the reference to "the licence application" includes a reference to:

- (a) the applications for any licences (including former pollution control approvals) which this licence replaces under the Protection of the Environment Operations (Savings and Transitional) Regulation 1998; and
- (b) the licence information form provided by the licensee to the EPA to assist the EPA in connection with the issuing of this licence.

2 Discharges to air and water and applications to land

P1 Location of monitoring/discharge points and areas

Environment Protection Licence



Licence - 11700

- P1.1 Not applicable.
- P1.2 The following points referred to in the table are identified in this licence for the purposes of the monitoring and/or the setting of limits for discharges of pollutants to water from the point.
- P1.3 The following utilisation areas referred to in the table below are identified in this licence for the purposes of the monitoring and/or the setting of limits for any application of solids or liquids to the utilisation area.

Water and land

EPA identification no.	Type of monitoring point	Type of discharge point	Description of location
1	Groundwater quality monitoring		Monitoring bore labelled as 'A' on map titled 'Plan showing proposed tyre landfill site within Lot 1 in DP123962 - Level Crossing Road, Vineyard, NSW' submitted to the EPA on 31.10.02.
2	Groundwater quality monitoring		Monitoring bore labelled as 'B' on map titled 'Plan showing proposed tyre landfill site within Lot 1 in DP123962 - Level Crossing Road, Vineyard, NSW' submitted to the EPA on 31.10.02

3 Limit conditions

L1 Pollution of waters

- L1.1 Except as may be expressly provided in any other condition of this licence, the licensee must comply with section 120 of the Protection of the Environment Operations Act 1997.

L2 Load limits

- L2.1 Not applicable.
- L2.2 Not applicable.

L3 Concentration limits

Environment Protection Licence

Licence - 11700

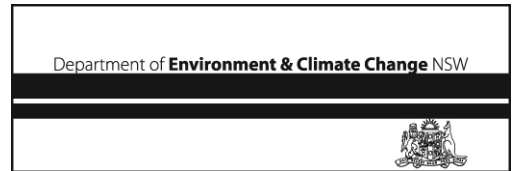

L3.1 Not applicable.

L3.2 Not applicable.

L3.3 Not applicable.

L4 Volume and mass limits

L4.1 Not applicable.

L5 Waste

L5.1 The licensee must not cause, permit or allow any waste generated outside the premises to be received at the premises for storage, treatment, processing, reprocessing or disposal or any waste generated at the premises to be disposed of at the premises, except as expressly permitted by the licence.

L5.2 This condition only applies to the storage, treatment, processing, reprocessing or disposal of waste at the premises if those activities require an environment protection licence.

L5.3 Except as provided by any other condition of this licence, only the inert waste listed below may be treated, processed, reprocessed or stored at the premises.

- 7 Tyres
- 7 Shredded tyres
- 7 Tyre pieces

L5.4 The quantity of used, rejected or unwanted tyres (including shredded tyres and tyre pieces) and inert waste stockpiled on the premises must not exceed 16 tonnes at any one time.

L6 Noise Limits

L6.1 Not applicable.

L7 Hours of Operation

L7.1 All work at the premises must be conducted between the following hours:
- 9 am to 4pm Monday to Saturday .



4 Operating conditions

O1 Activities must be carried out in a competent manner

O1.1 Licensed activities must be carried out in a competent manner.

This includes:

- (a) the processing, handling, movement and storage of materials and substances used to carry out the activity; and
- (b) the treatment, storage, processing, reprocessing, transport and disposal of waste generated by the activity.

O2 Maintenance of plant and equipment

O2.1 All plant and equipment installed at the premises or used in connection with the licensed activity:

- (a) must be maintained in a proper and efficient condition; and
- (b) must be operated in a proper and efficient manner.

O3 Tyre Storage

O3.1 The licensee must ensure that stockpiles of used, rejected or unwanted tyres (including shredded tyres and tyre pieces) are located in a clearly defined area.

O3.2 The licensee must ensure that stockpiles of used, rejected or unwanted tyres (including shredded tyres and tyre pieces) are managed so as not to cause or to be likely to cause the spread of disease by vermin.

O3.3 Without limiting 05.1 to 05.4, any area(s) used for the storage of used rejected or unwanted tyres (including shredded tyres and tyre pieces) at the facility must:

- (a) be surrounded by a fire break of at least six (6) metres width that is kept clear of all combustible material; and
- (b) be fenced or otherwise secured to prevent any unauthorised access to the tyres and the fire break.

O3.4 The licensee must ensure that any tyres stored above ground are located so that they are capable of being removed from the premises or buried prior to inundation of the site by floodwater.

O4 Dust Control

O4.1 The premises must be maintained in a condition which minimises or prevents the emission of dust from the premises.

O5 Management of the cells

Environment Protection Licence

Licence - 11700



- O5.1 The licensee must ensure that no more than three (3) cells are open at any one time.
- O5.2 The dimensions of the cells:
- (a) must not exceed a length of 8.1 metres or a width of 6 metres, and
 - (b) must maintain a depth to a level which is not less than 500mm above the underlying ground water.

O6 Site Management

- O6.1 The licensee must ensure that no soil erosion from the stockpiles of excavated material on the premises occurs.
- O6.2 The minimum finished surface grade of the filled land must be battered to 2% in order to allow satisfactory surface runoff and overcome potential or water logging above the finished tyre cells.

5 Monitoring and recording conditions

M1 Monitoring records

- M1.1 The results of any monitoring required to be conducted by this licence or a load calculation protocol must be recorded and retained as set out in this condition.
- M1.2 All records required to be kept by this licence must be:
- (a) in a legible form, or in a form that can readily be reduced to a legible form;
 - (b) kept for at least 4 years after the monitoring or event to which they relate took place; and
 - (c) produced in a legible form to any authorised officer of the EPA who asks to see them.
- M1.3 The following records must be kept in respect of any samples required to be collected for the purposes of this licence:
- (a) the date(s) on which the sample was taken;
 - (b) the time(s) at which the sample was collected;
 - (c) the point at which the sample was taken; and
 - (d) the name of the person who collected the sample.

M2 Requirement to monitor concentration of pollutants discharged

- M2.1 For each monitoring/discharge point or utilisation area specified below (by a point number), the licensee must monitor (by sampling and obtaining results by analysis) the concentration of each pollutant specified in Column 1. The licensee must use the sampling method, units of measure, and sample at the frequency, specified opposite in the other columns:

Environment Protection Licence

Licence - 11700



Water and Land

POINT 1

Pollutant	Units of measure	Frequency	Sampling Method
Alkalinity (as calcium carbonate)	milligrams per litre	Every 6 months	Grab sample
Cadmium	milligrams per litre	Every 6 months	Grab sample
Chloride	milligrams per litre	Every 6 months	Grab sample
Conductivity	microsiemens per centimetre	Every 6 months	Grab sample
Lead	milligrams per litre	Every 6 months	Grab sample
Sulfate	milligrams per litre	Every 6 months	Grab sample
Total Iron	milligrams per litre	Every 6 months	Grab sample
Total Zinc	milligrams per litre	Every 6 months	Grab sample
pH	pH	Every 6 months	Grab sample

POINT 2

Pollutant	Units of measure	Frequency	Sampling Method
Alkalinity (as calcium carbonate)	milligrams per litre	Every 6 months	Grab sample
Cadmium	milligrams per litre	Every 6 months	Grab sample
Chloride	milligrams per litre	Every 6 months	Grab sample
Conductivity	microsiemens per centimetre	Every 6 months	Grab sample
Lead	milligrams per litre	Every 6 months	Grab sample
Sulfate	milligrams per litre	Every 6 months	Grab sample
Total Iron	milligrams per litre	Every 6 months	Grab sample
Total Zinc	milligrams per litre	Every 6 months	Grab sample
pH	pH	Every 6 months	Grab sample

M3 Testing methods - concentration limits

M3.1 Not applicable.

M3.2 Subject to any express provision to the contrary in this licence, monitoring for the concentration of a pollutant discharged to waters or applied to a utilisation area must be done in accordance with the Approved Methods Publication unless another method has been approved by the EPA in writing before any tests are conducted.

M4 Recording of pollution complaints

Environment Protection Licence

Licence - 11700

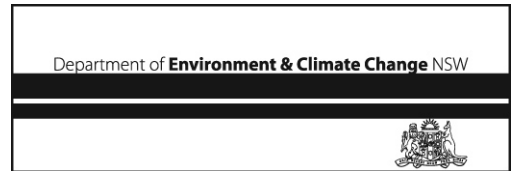

- M4.1 The licensee must keep a legible record of all complaints made to the licensee or any employee or agent of the licensee in relation to pollution arising from any activity to which this licence applies.
- M4.2 The record must include details of the following:
- (a) the date and time of the complaint;
 - (b) the method by which the complaint was made;
 - (c) any personal details of the complainant which were provided by the complainant or, if no such details were provided, a note to that effect;
 - (d) the nature of the complaint;
 - (e) the action taken by the licensee in relation to the complaint, including any follow-up contact with the complainant; and
 - (f) if no action was taken by the licensee, the reasons why no action was taken.
- M4.3 The record of a complaint must be kept for at least 4 years after the complaint was made.
- M4.4 The record must be produced to any authorised officer of the EPA who asks to see them.

M5 Telephone complaints line

- M5.1 The licensee must operate during its operating hours a telephone complaints line for the purpose of receiving any complaints from members of the public in relation to activities conducted at the premises or by the vehicle or mobile plant, unless otherwise specified in the licence.
- M5.2 The licensee must notify the public of the complaints line telephone number and the fact that it is a complaints line so that the impacted community knows how to make a complaint.
- M5.3 Conditions M5.1 and M5.2 do not apply until 3 months after:
- (a) the date of the issue of this licence or
 - (b) if this licence is a replacement licence within the meaning of the Protection of the Environment Operations (Savings and Transitional) Regulation 1998, the date on which a copy of the licence was served on the licensee under clause 10 of that regulation.

M6 Requirement to monitor volume or mass

- M6.1 Not applicable.

6 Reporting conditions

R1 Annual return documents

What documents must an Annual Return contain?

Environment Protection Licence

Licence - 11700

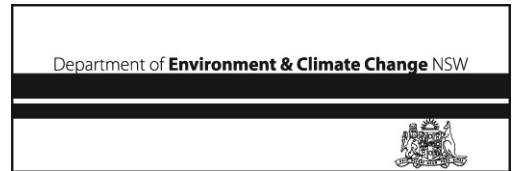

- R1.1 The licensee must complete and supply to the EPA an Annual Return in the approved form comprising:
- (a) a Statement of Compliance; and
 - (b) a Monitoring and Complaints Summary.
- A copy of the form in which the Annual Return must be supplied to the EPA accompanies this licence. Before the end of each reporting period, the EPA will provide to the licensee a copy of the form that must be completed and returned to the EPA.

Period covered by Annual Return

- R1.2 An Annual Return must be prepared in respect of each reporting period, except as provided below.

Note: The term "reporting period" is defined in the dictionary at the end of this licence. Do not complete the Annual Return until after the end of the reporting period.

- R1.3 Where this licence is transferred from the licensee to a new licensee:
- (a) the transferring licensee must prepare an Annual Return for the period commencing on the first day of the reporting period and ending on the date the application for the transfer of the licence to the new licensee is granted; and
 - (b) the new licensee must prepare an Annual Return for the period commencing on the date the application for the transfer of the licence is granted and ending on the last day of the reporting period.

Note: An application to transfer a licence must be made in the approved form for this purpose.

- R1.4 Where this licence is surrendered by the licensee or revoked by the EPA or Minister, the licensee must prepare an Annual Return in respect of the period commencing on the first day of the reporting period and ending on:
- (a) in relation to the surrender of a licence - the date when notice in writing of approval of the surrender is given; or
 - (b) in relation to the revocation of the licence - the date from which notice revoking the licence operates.

Deadline for Annual Return

- R1.5 The Annual Return for the reporting period must be supplied to the EPA by registered post not later than 60 days after the end of each reporting period or in the case of a transferring licence not later than 60 days after the date the transfer was granted (the 'due date').

Notification where actual load can not be calculated

- R1.6 Not applicable.

Licensee must retain copy of Annual Return

- R1.7 The licensee must retain a copy of the Annual Return supplied to the EPA for a period of at least 4 years after the Annual Return was due to be supplied to the EPA.

Certifying of Statement of Compliance and signing of Monitoring and Complaints Summary

- R1.8 Within the Annual Return, the Statement of Compliance must be certified and the Monitoring and Complaints Summary must be signed by:

Environment Protection Licence

Licence - 11700

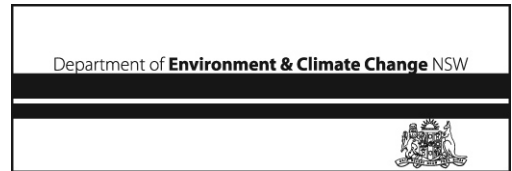

- (a) the licence holder; or
- (b) by a person approved in writing by the EPA to sign on behalf of the licence holder.

R1.9 A person who has been given written approval to certify a certificate of compliance under a licence issued under the Pollution Control Act 1970 is taken to be approved for the purpose of this condition until the date of first review of this licence.

R2 Notification of environmental harm

Note: The licensee or its employees must notify the EPA of incidents causing or threatening material harm to the environment as soon as practicable after the person becomes aware of the incident in accordance with the requirements of Part 5.7 of the Act.

R2.1 Notifications must be made by telephoning the EPA's Pollution Line service on 131 555.

R2.2 The licensee must provide written details of the notification to the EPA within 7 days of the date on which the incident occurred.

R3 Written report

R3.1 Where an authorised officer of the EPA suspects on reasonable grounds that:

- (a) where this licence applies to premises, an event has occurred at the premises; or
- (b) where this licence applies to vehicles or mobile plant, an event has occurred in connection with the carrying out of the activities authorised by this licence,

and the event has caused, is causing or is likely to cause material harm to the environment (whether the harm occurs on or off premises to which the licence applies), the authorised officer may request a written report of the event.

R3.2 The licensee must make all reasonable inquiries in relation to the event and supply the report to the EPA within such time as may be specified in the request.

R3.3 The request may require a report which includes any or all of the following information:

- (a) the cause, time and duration of the event;
- (b) the type, volume and concentration of every pollutant discharged as a result of the event;
- (c) the name, address and business hours telephone number of employees or agents of the licensee, or a specified class of them, who witnessed the event;
- (d) the name, address and business hours telephone number of every other person (of whom the licensee is aware) who witnessed the event, unless the licensee has been unable to obtain that information after making reasonable effort;
- (e) action taken by the licensee in relation to the event, including any follow-up contact with any complainants;
- (f) details of any measure taken or proposed to be taken to prevent or mitigate against a recurrence of such an event; and
- (g) any other relevant matters.

R3.4 The EPA may make a written request for further details in relation to any of the above matters if it

Environment Protection Licence

Licence - 11700

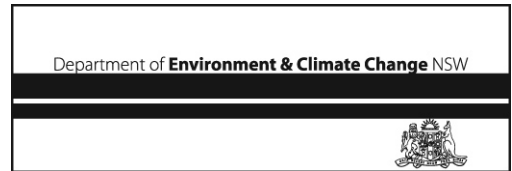

is not satisfied with the report provided by the licensee. The licensee must provide such further details to the EPA within the time specified in the request.

R4 Recording of fires

- R4.1 The licensee must maintain a daily log and record the following data of fires at the site:
- (a) Time and date when the fire was deliberately started or reported.
 - (b) Whether the fire was authorised by the licensee, and, if not, the circumstances which ignited the fire.
 - (c) The time and date that the fire ceased and whether it burnt out or was extinguished.
 - (d) The location of fire (eg. clean timber stockpile, putrescible garbage cell, etc).
 - (e) Prevailing weather conditions.
 - (f) Observations made in regard to smoke direction and dispersion.
 - (g) The amount of waste that was combusted by the fire.
 - (h) Action taken to extinguish the fire.
- R4.2 The licensee or its employees or agents must notify the EPA in accordance with conditions R2.1 and R2.2 of all fires at the premises as soon as practical after becoming aware of the incident.

General conditions

G1 Copy of licence kept at the premises

- G1.1 A copy of this licence must be kept at the premises to which the licence applies.
- G1.2 The licence must be produced to any authorised officer of the EPA who asks to see it.
- G1.3 The licence must be available for inspection by any employee or agent of the licensee working at the premises.

Pollution studies and reduction programs

U1 Submission of a Closure Plan

The licensee must prepare and submit to the EPA a closure plan in accordance with Section 76 of the Protection of the Environment Operations Act 1997. The closure plan must be submitted to the Manager Sydney Waste PO Box A290 Sydney South NSW 1232 by **5pm Monday 9 May 2005**.

The closure plan must address the following;

- (a) be consistent with any environmental waste management plan relating to the facility, and
- (b) be consistent with the benchmark techniques stated in the "Environmental Guidelines: Solid Waste Landfills January 1996", and

Environment Protection Licence



Licence - 11700

- (c) specify the steps taken (or to be taken) in closing and stabilising the premises and the time-frame for doing so, and
- (d) specify any potential environmental impacts likely to occur from the licensed activity, and
- (e) specify steps to be taken to investigate and manage the identified potential environmental impacts and the timeframe for doing so, and
- (f) identify any proposed future uses of the premises, and
- (g) any other information or steps required in closing and stabilising the premises.

Special conditions

E1 Financial Assurance

- E1.1 A financial assurance, in favour of the EPA, in the form of an irrevocable and unconditional guarantee from a bank, building society or credit union to the amount of fifty thousand dollars (\$50,000) must be maintained during the operation of the facility and thereafter until such time as the EPA is satisfied the premises is environmentally secure.
- E1.2 This assurance must be replenished to the full amount should the EPA have any reason to call up the financial assurance or any part thereof to correct environmental problems which have not been remedied by the occupier upon being given notice to do so.
- E1.3 This financial assurance shall be indexed to the Consumer Price Index (CPI). The EPA reserves the right to vary the magnitude of the bank guarantee at any time depending upon any reassessment of possible cost(s) of rehabilitation of the premises.

Dictionary

General Dictionary

In this licence, unless the contrary is indicated, the terms below have the following meanings:

3DGM [in relation to a concentration limit]	Means the three day geometric mean, which is calculated by multiplying the results of the analysis of three samples collected on consecutive days and then taking the cubed root of that amount. Where one or more of the samples is zero or below the detection limit for the analysis, then 1 or the detection limit respectively should be used in place of those samples
Act	Means the Protection of the Environment Operations Act 1997
activity	Means a scheduled or non-scheduled activity within the meaning of the Protection of the Environment Operations Act 1997
actual load	Has the same meaning as in the Protection of the Environment Operations (General) Regulation 1998
AM	Together with a number, means an ambient air monitoring method of that number prescribed by the <i>Approved Methods for the Sampling and Analysis of Air Pollutants in New South Wales</i> .
AMG	Australian Map Grid

Environment Protection Licence



Licence - 11700

anniversary date	The anniversary date is the anniversary each year of the date of issue of the licence. In the case of a licence continued in force by the Protection of the Environment Operations Act 1997, the date of issue of the licence is the first anniversary of the date of issue or last renewal of the licence following the commencement of the Act.
annual return	Is defined in R1.1
Approved Methods Publication	Has the same meaning as in the Protection of the Environment Operations (General) Regulation 1998
assessable pollutants	Has the same meaning as in the Protection of the Environment Operations (General) Regulation 1998
BOD	Means biochemical oxygen demand
CEM	Together with a number, means a continuous emission monitoring method of that number prescribed by the <i>Approved Methods for the Sampling and Analysis of Air Pollutants in New South Wales</i> .
COD	Means chemical oxygen demand
composite sample	Unless otherwise specifically approved in writing by the EPA, a sample consisting of 24 individual samples collected at hourly intervals and each having an equivalent volume.
cond.	Means conductivity
environment	Has the same meaning as in the Protection of the Environment Operations Act 1997
environment protection legislation	Has the same meaning as in the Protection of the Environment Administration Act 1991
EPA	Means Environment Protection Authority of New South Wales.
fee-based activity classification	Means the numbered short descriptions in Schedule 1 of the Protection of the Environment Operations (General) Regulation 1998.
flow weighted composite sample	Means a sample whose composites are sized in proportion to the flow at each composites time of collection.
grab sample	Means a single sample taken at a point at a single time
hazardous waste	Has the same meaning as in Part 3 of Schedule 1 of the Protection of the Environment Operations Act 1997
industrial waste	Has the same meaning as in Part 3 of Schedule 1 of the Protection of the Environment Operations Act 1997
inert waste	Has the same meaning as in Part 3 of Schedule 1 of the Protection of the Environment Operations Act 1997
licensee	Means the licence holder described at the front of this licence
load calculation protocol	Has the same meaning as in the Protection of the Environment Operations (General) Regulation 1998
local authority	Has the same meaning as in the Protection of the Environment Operations Act 1997
material harm	Has the same meaning as in section 147 Protection of the Environment Operations Act 1997
MBAS	Means methylene blue active substances
Minister	Means the Minister administering the Protection of the Environment Operations Act 1997
mobile plant	Has the same meaning as in Part 3 of Schedule 1 of the Protection of the Environment Operations Act

Environment Protection Licence



Licence - 11700

	1997
motor vehicle	Has the same meaning as in the Protection of the Environment Operations Act 1997
O&G	Means oil and grease
percentile [in relation to a concentration limit of a sample]	Means that percentage [eg.50%] of the number of samples taken that must meet the concentration limit specified in the licence for that pollutant over a specified period of time. In this licence, the specified period of time is the Reporting Period unless otherwise stated in this licence.
plant	Includes all plant within the meaning of the Protection of the Environment Operations Act 1997 as well as motor vehicles.
pollution of waters [or water pollution]	Has the same meaning as in the Protection of the Environment Operations Act 1997
premises	Means the premises described in condition A2.1
public authority	Has the same meaning as in the Protection of the Environment Operations Act 1997
regional office	Means the relevant EPA office referred to in the Contacting the EPA document accompanying this licence
reporting period	For the purposes of this licence, the reporting period means the period of 12 months after the issue of the licence, and each subsequent period of 12 months. In the case of a licence continued in force by the Protection of the Environment Operations Act 1997, the date of issue of the licence is the first anniversary of the date of issue or last renewal of the licence following the commencement of the Act.
reprocessing of waste	Has the same meaning as in Part 3 of Schedule 1 of the Protection of the Environment Operations Act 1997
scheduled activity	Means an activity listed in Schedule 1 of the Protection of the Environment Operations Act 1997
solid waste	Has the same meaning as in Part 3 of Schedule 1 of the Protection of the Environment Operations Act 1997
TM	Together with a number, means a test method of that number prescribed by the <i>Approved Methods for the Sampling and Analysis of Air Pollutants in New South Wales</i> .
treatment of waste	Has the same meaning as in Part 3 of Schedule 1 of the Protection of the Environment Operations Act 1997
TSP	Means total suspended particles
TSS	Means total suspended solids
Type 1 substance	Means the elements antimony, arsenic, cadmium, lead or mercury or any compound containing one or more of those elements
Type 2 substance	Means the elements beryllium, chromium, cobalt, manganese, nickel, selenium, tin or vanadium or any compound containing one or more of those elements
utilisation area	Means any area shown as a utilisation area on a map submitted with the application for this licence
waste	Has the same meaning as in the Protection of the Environment Operations Act 1997
waste code	Means the waste codes listed in Appendix 5 of the EPA document A Guide to Licensing Part B.
waste type	Means Group A, Group B, Group C, inert, solid, industrial or hazardous waste

Environment Protection Licence

Licence - 11700



Ms Gillian Reffell

Environment Protection Authority

(By Delegation)

Date of this edition - 05-Dec-2007

End Notes

- 1 Licence varied by notice 1040005, issued on 17-Sep-2004, which came into effect on 12-Oct-2004.
- 2 Licence varied by notice 1046093, issued on 01-Apr-2005, which came into effect on 26-Apr-2005.
- 3 This licence was surrendered subject to conditions by notice 1080862 on 04-Dec-2007.



MSK
840

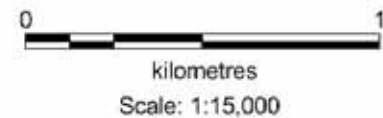

CLIENT: Mott MacDonald Australia Pty Ltd
OFFICE: Sydney DRAWN BY: NLE
SCALE: As shown DATE: 5.09.2014

TITLE: **Historical Aerial Photograph - 1961**
Land Capability, Salinity and Contamination
Vineyard Precinct



PROJECT No: 73895
DRAWING No: D1
REVISION: A



kilometres

Scale: 1:18,020



CLIENT: Mott MacDonald Australia Pty Ltd

OFFICE: Sydney

SCALE: As shown

DRAWN BY: NLE

DATE: 5.09.2014

TITLE: **Historical Aerial Photograph - 1970**

**Land Capability, Salinity and Contamination
Vineyard Precinct**



PROJECT No: 73895

DRAWING No: D2

REVISION: A

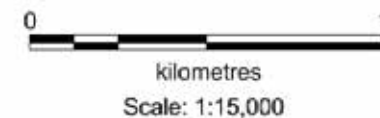
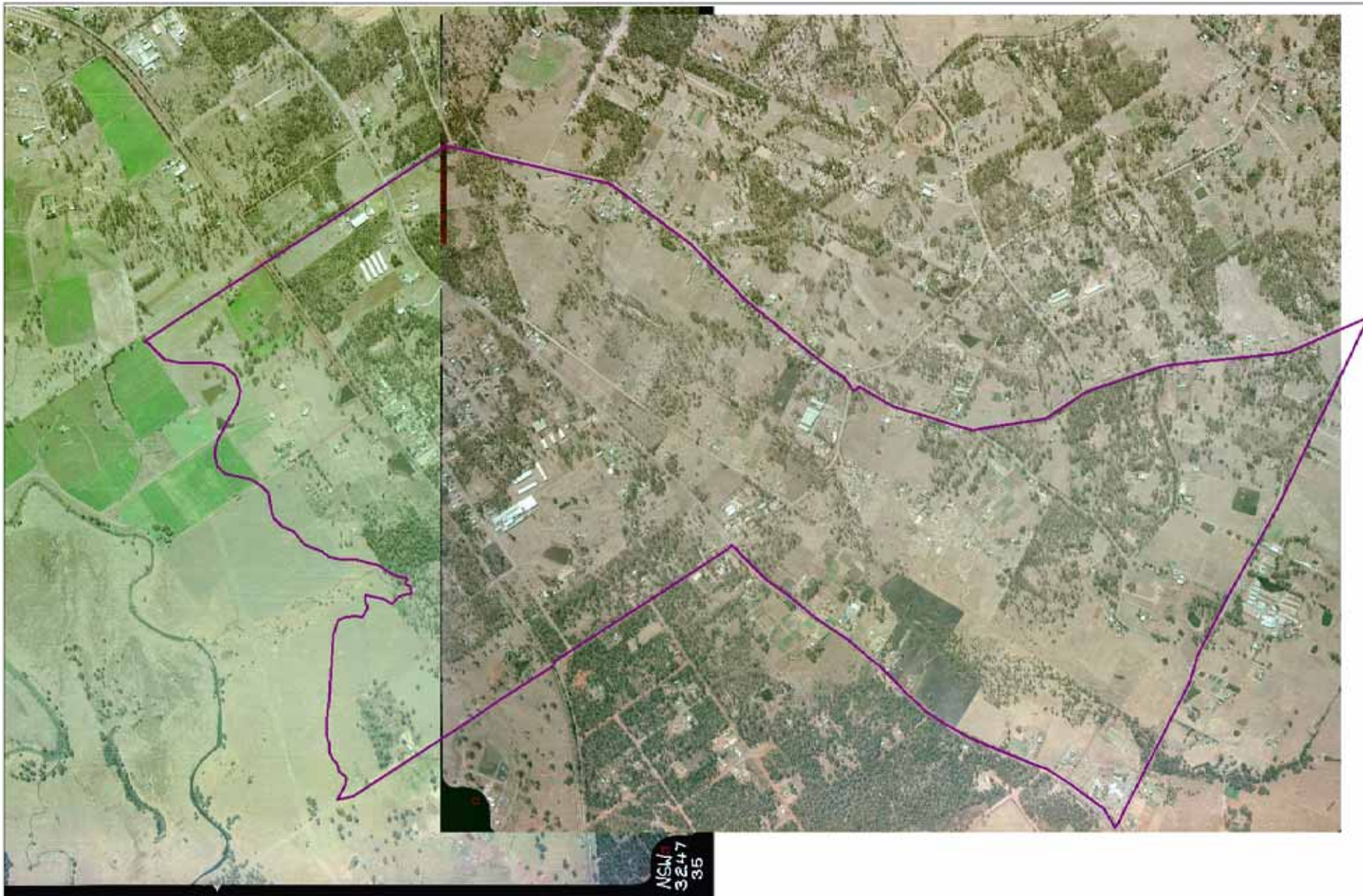

CLIENT: Mott MacDonald Australia Pty Ltd
 OFFICE: Sydney DRAWN BY: NLE
 SCALE: As shown DATE: 5.09.2014

TITLE: **Historical Aerial Photograph - 1982**
Land Capability, Salinity and Contamination
Vineyard Precinct



PROJECT No: 73895
 DRAWING No: D3
 REVISION: A



kilometres

Scale: 1:15,000



CLIENT: Mott MacDonald Australia Pty Ltd
 OFFICE: Sydney
 SCALE: As shown

DRAWN BY: NLE
 DATE: 5.09.2014

TITLE: **Historical Aerial Photograph - 1991**
Land Capability, Salinity and Contamination
Vineyard Precinct



PROJECT No: 73895
 DRAWING No: D4
 REVISION: A

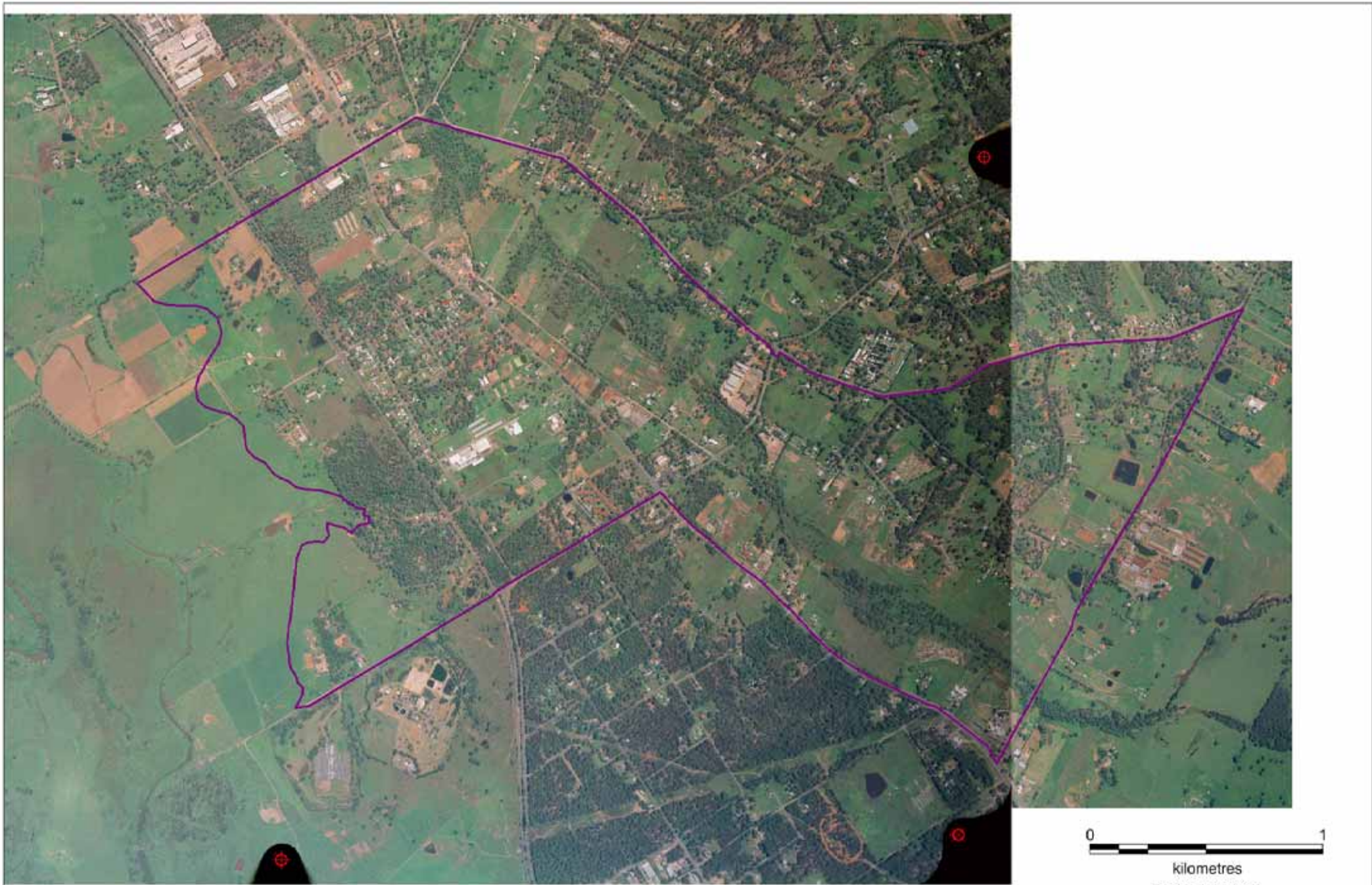

WHO WAS WHO? OF VINEYARD & WHAT WAS WHERE?

During the early days at Vineyard there were many properties within the settlement of the Pitt Town Common, which later became known as Vineyard. The small settlement was also known as "The Vineyard" owing to the many vineyards that were operated within the district. With the early days in mind, I have included where people lived in the 1800s, to the 1900s, and the location of the important buildings. I might mention that of all the old important buildings at Vineyard, only two exist. They are the old Dance Hall built in 1933, come Picture Theatre, then Hardware, followed by Stockman's Steak House, "The Drover's Hat" and now a "Trailer" business, and The Vineyard Public School which was erected in 1956. Therefore, I have prepared a map of my knowledge of the Vineyard district during my time of living in the district from the 1943 until 1960s, along with numerous other people who lived in the district.

To read the map, I have placed numbers on each road. For example, say from 1 to 20 on Windsor Road from Boundary Road to Groves Avenue. 1 to 4 in Ashford Road and so on. Appearing hereunder are the numbers of each road or location, with the then residents names who lived there. Say, for instance, in Hawkesbury Road No. 1 – Alcorn, Strachan, Moon, McCormack, Gross, King, Bland. All these people lived at this slab cottage residence, which consisted of three small buildings. It was the first Post Office at Vineyard, which opened in 1895. The slab cottage was built by Robert Alcorn in the late 1800s. It was demolished during the late 1960s.

For other places of interest that appear in the Vineyard bush, instead of using numbers, I have placed the letters of the alphabet. For instance "A" for Brown's Dam, "B" for Beach's house.

WINDSOR ROAD

1. Joe Newton's Shop, Bill Wormleaton's Shop, Jack Sidthorpe's Shop.
2. Purvives.
3. Newton's owned a house and poultry farm.
4. Bill Granger's Shop.
5. B. P. Service Station – Walter "Wally" Wormleaton, Mr Barr.
6. Ada Schoffel, Les Baston – Trotting Track, then Tom Sewell's Race Horse Training Establishment, then Vineyard "Tourmaline" Hotel - Motel, owned by Tom Sewell and Jack Jones.
7. Vineyard Bush-fire Shed.
8. Alfie Skeers.
9. Loman's land.
10. White's.
11. Brian and Phil Windybank.
12. Mr Fletcher.
13. Frank & Daisy May Hardcastle

14. Diane Cohen, James Barnett "Bee-Hive" Inn, James Strachan, McNamara, Stracy, Shoe's.
15. Mary and Ernest Boardman, and family:- John, Henry, Colin, Robert, Fay.
16. James & Robert Strachan's farm land, Kenny, Joseph Harding, Edmund Jenkins, Charlotte & Norman Alcorn, Cecil & Sophie Marsh.
17. Marsh's Dam.
18. Bruce & Vivian Cole's - "Colesway Removalists Vineyard".
19. Frank Gross Mushroom Farm, Moon's Fish Hatchery, Garden centre.
20. Robert Strachan's Farm, Kenny, Joseph Harding, Edmund Jenkins, John McLean.
21. Albert Gross – Market Garden – Cabbages and vegetables.
22. Beryl and Frank Barnes. Also ruins of old house.
23. Bill Wormleaton's Shop, Frank Vella, Agostino Bros. Fruit Market, Mango One.
24. "Antique & Vintage Goods" – Louey Agostino.
25. St Andrews Vineyard Parish Church, Vineyard Boy Scouts, Class Room, Forge Real Estate, Pet Suppliers.
26. "Jack & Jill" Picnic Ground and Motor Cycle Race Track.
27. Hough's Land, Edward McNamara, Nelson, Frank Gross, Ray & Francis Flannery, Fit Kidz Vineyard Day-Care & Pre-School.
28. Vineyard Bush-Fire Siren on Pole. [Worked from Wilson's/Rannard's Shop]
29. Robert Strachan's Land, 1ST Vineyard Public School, School Tennis Court, and 2ND Vineyard Public School.
30. John Hancock's Land, Bloodsworth, Eves Shop, Wilson/Rannard Shop and Post Office, Commonwealth Bank, General Store, Henry "Fish & Chip" Shop.
31. Piggery sheds, sty and Poultry Farm and sheds.
32. Rivoli Dance Hall, Rivoli Picture Theatre, Vineyard Hardware, Stockman's Steak House, Drover's Shed, trailer sales.
33. Leherne's Land, Vineyard Provisional School, Hanrahan's, Brown's Paddock, Hepburn & Jones.
34. Hanrahan, Brown, Arthur & Lilian Strachan. [House], "Ascania" Poultry Farm.
35. Chinese Restaurant – Health Food Centre, Mr A. Haas, Mutti's Family Restaurant, Windsor Restaurant, County Road Restaurant, Vineyard Art Gallery.
36. Peter "Chook" Fowler Poultry Farm, Howard's Poultry Farm. Henry's Sawmill.
37. Liston - Printing Shop. Liston owned from Wallace Road to Windsor Road.
38. Laymore Chicks.
39. Mrs Cotterell. [had a club foot and was built up with metal foot].

40. Yvonne Morley & Biddle. [remains of old Vineyard Church].
41. William Farrell's Farm, Windsor Farm Equipment.
42. Edward "Ted" Cunen's Tea-room -shop and California Park Picnic Grounds, Ward's Shop, Irons Shop, Vineyard Ski-Shop.
43. Vineyard Mission Church/School.
44. Sam Pollock's Shop, Cyril Latona's "The Trees Service Centre" and shop, also "Trees Picnic Pleasure Grounds" -- horse, pony, donkey rides.
45. "Stone Garden Nursery" next to "The Trees Pleasure Grounds".
46. Quinn family.
47. Little family.
48. Schofield's Bush, Schofield's Vineyards.
49. James Clout. [son Cyrus Clout killed in action in World War 1].
50. Vineyard – Main Roads Depot.
51. Smallwood, Kelly, Cusbert Family. Ron Cusbert - Blacksmith.
52. "Nanny" Brennan's House and shop, George Gill, Electricity Commission, Vineyard Christian Life Centre, Hawkesbury Church Vineyard.
53. Elf Farm Supplies Pty. Ltd.
54. Vineyard Park [recreation reserve].
55. C. J. E. Forssberg, Johnston Cottage – Eric and Daphne Strachan.
56. Thomas Brennan, Austie Brennan, Bill Wormleation.
57. Brennan's Dam.
58. E. Liddle, Alwyn Medcalf's Mushroom Sheds.
59. E. Liddle, Medcalf's Shop and Tea-rooms, Butler, Bowd, Gosis.
60. Kelly's new house.
61. Millership Shop.
62. Groves Roadhouse, Tea-rooms, restaurant, tennis courts and Pavilion, Black Stump, McDonald's.
63. W. H. Spinks Land.

OLD HAWKESBURY ROAD

1. Edward McNamara's iron bark slab cottage.
2. John Robert Alcorn's Farm, 1ST Vineyard Post Office, Moon's, John McCormack, Asher, Frank Gross, King, Bland.
3. Angus McMillan's Farm.
4. Daniel "Dan" Cuneens, 2ND Vineyard Post Office.

5. E. J. Fagerlund, Joy Corsi.
6. Andrew McGregor's large property.
7. Brennan.
8. Charles Honeman.

BOUNDARY ROAD [FORESTER ROAD]

1. Quilan.
2. Ada Schoffel, Les Bastin.
4. John Darcy.
5. Harry Newton's house and Poultry Farm.
6. Suttor, Frank Godfrey, Tom Uren – Poultry Farm and Orange Orchard.

COMMERCIAL ROAD

1. Godfrey – Strachan.
2. Pilon, Burchell, McDonald.
3. Stockwell, McPherson, Taylor.
4. Sims, Miss Morrish Poultry Farm.
5. George & Bridget Laggan.
6. Charles Chapman, King, Powell. "Purr-Pull" Petrol Depot.
7. Latham, Hugh O'Kane, Peter Hill, Jim Wilkinson, George Bush - Dairy Farm. Les & Isabell Bailey.
8. Charles Chapman – dairy farm, Vineyard Caravan Park – Ian McErlane.
9. John Gray, John Beverley – Poultry Farm.
10. Robertson, Isobel Rickard, Fisher - Electrician.
11. Veech -- Poultry Farm.
12. Druch – Poultry Farm.
13. Walker – Poultry Farm.
14. Harding – Poultry Farm.
15. Mrs Ruth Davison – Poultry Farm [Marshall Davison].
16. Johnston Properties.
17. Charles Palmer, John "Jack" Brennan – Dairy Farm.
18. Thomas Hudson, "Jock" Good – Dairy Farm and T. T. Motor Cycle Race Track.

GLENIDOL ROAD [BUSH TRACK]

1. John "Jack" Kelly – Oxy Welder and Factory.

BOCKS ROAD

1. Byron, Arthur Johnson – Cattle Farm.
2. Lilian Byron.

MENIN ROAD

1. Gale, Bradshaw – Poultry Farm.
2. Patrick McKeever, John Cassidy – Poultry Farm.
3. John Nicholson – Poultry Farm.
4. Pestall.
5. Herman.

HARKNESS ROAD

1. Bridget Moran, Mc Swiggin – Poultry Farm.
2. Harkness, Aliaz, Roger Lowe – Mushroom Farm.
3. Harkness, Sharpe.

LANEWAY OFF BANDON ROAD [NOW CHAPMAN ROAD]

1. Miller's Demolisher's Timber yard – Second-hand Timber etc.
2. Johnson Family – Geoff & Averil [Johnson] Bowd.

BANDON ROAD

1. Jean Taylor, Vineyard Art Gallery.
2. Vineyard Bush-fire brigade shed.
3. School Residence.
4. Windsor Retirement Village.
5. Motor Cycle Racing Track.
6. Vineyard Nursery.
7. Vineyard Children's Early Learning Centre & Pre-School.

DULWICH ROAD

1. Edward Steadman Alcorn & Clara Jane Hansell erected iron Bark Slab Cottage, Sid Alcorn & Orchard, Martin Gross, Bill Hannan.
2. Billy Hannan.
3. Mr Gordon, Monigan.
4. Mr Beach.
5. Gravel Pit No. 4.

CAMBERWELL ROAD

1. Hamilton, Mrs Hillier/Court, Arthur & Lilian Strachan.
2. Mrs Wenabon.
3. Johnson.

ASHFORD ROAD

1. John "Jack" Robbins and his wife. Children:- John - Jennifer - Margaret.
2. Frank & Amelia Strachan. Their children: Gloria - Eric - Mavis - Alan - Rosemary.
3. Market Garden.
4. Frank Strachan's Saw- Mill.
5. Air Raid Shelter.
6. Ricketty Creek.
7. Eric & Daphne [Murray] Strachan. Taken over by Gloria Strachan in 1960s.
8. P. C. Adams. Then late 1930s Fred & Lavetta Burden moved in - their children: Fred Jnr. & Ross. In mid 1950s Ritchie/Dehon took over. Peter Dehon was a son.
9. MacVetty.

NORWOOD ROAD

1. Vineyard Billy Cart Track.
2. Verbrick Family - Charlie Verbrick.
3. Roy & Dulcie Alcorn - Tennis Court & Poultry Farm, George Bond. - Poultry Farm & Radio and Television Repairs.

OTAGO ROAD/STREET

1. Vineyard Rubbish Tip.
2. Mr Jackson [in bush near Otago Road – later Brisbane Street].
3. Brazil's – Beverley & Trevor.
4. Old German Alf Wall [lived in wooden crate], Humpherbay.
5. Moon's, Billy Monk.
6. Stan & Thelma Alcorn.
7. Sid & Gladys Taylor.
8. Ernie & Dulcie Thiele, Bill Cook.
9. Chivels then Jeffrey Family - Juanita Jeffrey's.
10. Gloria Strachan.

UNION STREET

1. Jeffrey – Vineyard Panel Beater.

O'CONNELL ROAD

1. Jackson.
2. McLean's Property.
3. Marsh's Property
4. Megan Rowan, Gill/Moulds.
5. Ross & Beverley Burden.
6. Arthur & Eva Strachan - old Slab Cottage, Fred & Lavetta Burden.
7. William "Bill" Clout. [Cnr. O'Connell Road & Clyde Street].

CLYDE STREET

1. Mrs Yeardye.
2. Edward & Florence Burden - Milk Run, Jeffries.
3. Colin Freeman's tin shanty.

PERTH STREET

1. Billy Jackson.
2. Gwen & Stanley Dale.
3. Grace [Downs] Hunt, John Downs.
4. Freeman Family - Bill, Keith and Colin.

PRINCES STREET

1. Chris Richards - Vineyard Hire Car Service.

MELBOURNE STREET

1. Violet & Les Morton.
2. Blanche & Stan Fennell. [Cnr. Hamilton Street].
3. Christine Logan - Orange Orchard.
4. Water Stand-pipe.

HAMILTON STREET

1. Elaine & Bob Smith.
2. Harold Packham.
3. Keith Miles.
4. Tom & Marie Penfold.

5. Vineyard Two-Up School.
6. Alice & "Paddy" Packer. – Sawmill.
7. Mr Boyle.
8. Denton's tin shed house.
9. Leila, Lil, & Kerry Wherritt, Colin Freeman, Phillips and Carol Families.

WALLACE ROAD

[Commencing on Southern side of road – in earlier years this road actually ended at Searle's]

1. Mr Searle & Renie Searle had two sons Harry & Malcolm, and a daughter, Irene Searle. When Mr Searle passed away Renie then married Mr West, they had two children, Patricia "Patsy" and Robert "Bob" West. When Mr West passed away, Mrs Renie West married Darcy Edwards – Malcolm Searle, Patricia "Patsy" and Robert West all lived with their parents at Mr Searle's old house.
2. Austin Beech, Irene [Searle] Beech, Wanda Beech, Wayne Beech. – Ray Gavin.
3. Les Scanlon, Olive [Edwards] Scanlon, and son Barry Scanlon.
4. Darcy Edwards, [wife unknown] children:- Lionel- Clifford- Olive Edwards. From the late 1950s the residents was Joyce Moulds.
5. Early 1940s Mr Read lived at the house. Late 1940s Michael White and Phyliss Little lived at the house. Early 1950s Mr & Mrs Moore moved in and their sons were: Charles & Bruce Moore. – Then later Mr & Mrs Powell.
6. Mr & Mrs John Clark – their children:- Thomas - Laurence, Dorothy - Cyril. They moved to Newcastle area in late 1940s. House then taken over by Michael White & Phyliss Little, their children were:- Gaye - Philip - Michelle, plus a younger son who drowned in their dam. – Then along came Jones.
7. Keith Perrot & Dorothy [nee Clark] children:- Heather - Brian - Leon Perrot. New residents in 1952 - Mr & Mrs Albert Butler, sons:- Robert - Donald - Albery - Bruce.
8. Devine.
9. Albert Butler Junior. – Ron Andrews.
10. Frank Gross and wife Yvonne [Strachan] built a house in early 1970s. In 2007, Yvonne Gross and her two brothers, Darcy and James Strachan live there.
11. Aldridge.
12. Gillespie.
13. George & Anne Parker - their children:- George - Donald - Arthur - June - Ann and Mary Parker.
14. William Parker [grandfather] lived in two steam trams, and passed away about 1946. His children were:- George - Dorothy - Ada [Dorothy and Ada lived elsewhere]. Stan Kearns built a house on the property about 1950.

[Commencing on northern side of Wallace Road from Brown's property]

15. Vineyard Children's Early Learning Centre was established on five acres in Brown's old paddock in 2006 and opened in mid 2007 and is situated on the corner of Bandon Road and Wallace Road, on the north side of road.
16. Brown's property was at the end of Wallace Road in the early years. During this time the road ceased at their boundary fence of their property. Mr & Mrs John Leherene first owned this property, then Mr & Mrs Hanrahan and in 1941 the Brown Family took over the 147 acres property and established the large "Ascania" Poultry Farm. There was Mr Hubert Ashburton Brown, his wife Thekla and there six children:- Constance - Tom - Then twins:- Stuart and Keith - then Marcia and Wilma Brown. They were all born at Henty, down in the Riverina District of New South Wales. The Brown's left in 1955 and Mr Jones from Sydney bought the property. In the early 1960s Arthur Strachan and his wife Lilian [Godfrey] Strachan and their family:- Yvonne, Darcy and James Strachan moved in and leased the property house from Mr Jones. This property is also listed as being on Windsor Road, as the entry was gained from Windsor Road When Wallace Road was completed right through from Level Crossing Road to Bandon Road, the property house was gained by either of the two roads.
17. Rob Tolson took over part of Brown's old property and established a Mushroom Farm - "Elf Mushrooms" - "White Knight Mushrooms".
18. Liston owned all the property that ran down the side fence of Brown's from Wallace Road to Windsor Road. There was a small gravel pit on his property. Gravel Pit No. 4.
19. Mr & Mrs Baden Strause.
20. Mr "Pop" West before he married Mrs Searle.
21. Alan Blanksby arrived about 1950. There was a small gravel pit at the rear of his property. Gravel Pit No. 3.
22. Mrs Denton. Sons were:- Alfie and Tinkey. They arrived about 1950.
23. Mr Davis - he passed away about 1948 and the house was demolished.

LEVEL CROSSING ROAD

1. Arthur & Emily Wilcher House, "Wilcher's Dairy", Wilcher's Property. Daughter Jeanette Wilcher
2. Barbara Mathews.
3. Walker's Farm, Aid's Farm.
4. Davis Family on Corner of Wallace Road.
5. Diane Watts on Corner of Bruce Road.
6. Jim Clark.
7. Gravel Pit No. 1 on Schofield's Property.
8. Gravel Pit No. 2 on Schofield's Property.

[For later arrivals at Vineyard in Wallace Road, Level Crossing Road, Windsor Road, Bandon Road and other properties, see plan/map of this area]

RIVERSTONE/RAILWAY PARADE

1. Mr Gordon, then Mr Beech and his Indian wife.
2. John and Sarah Lucas.
3. E. Alcorn.

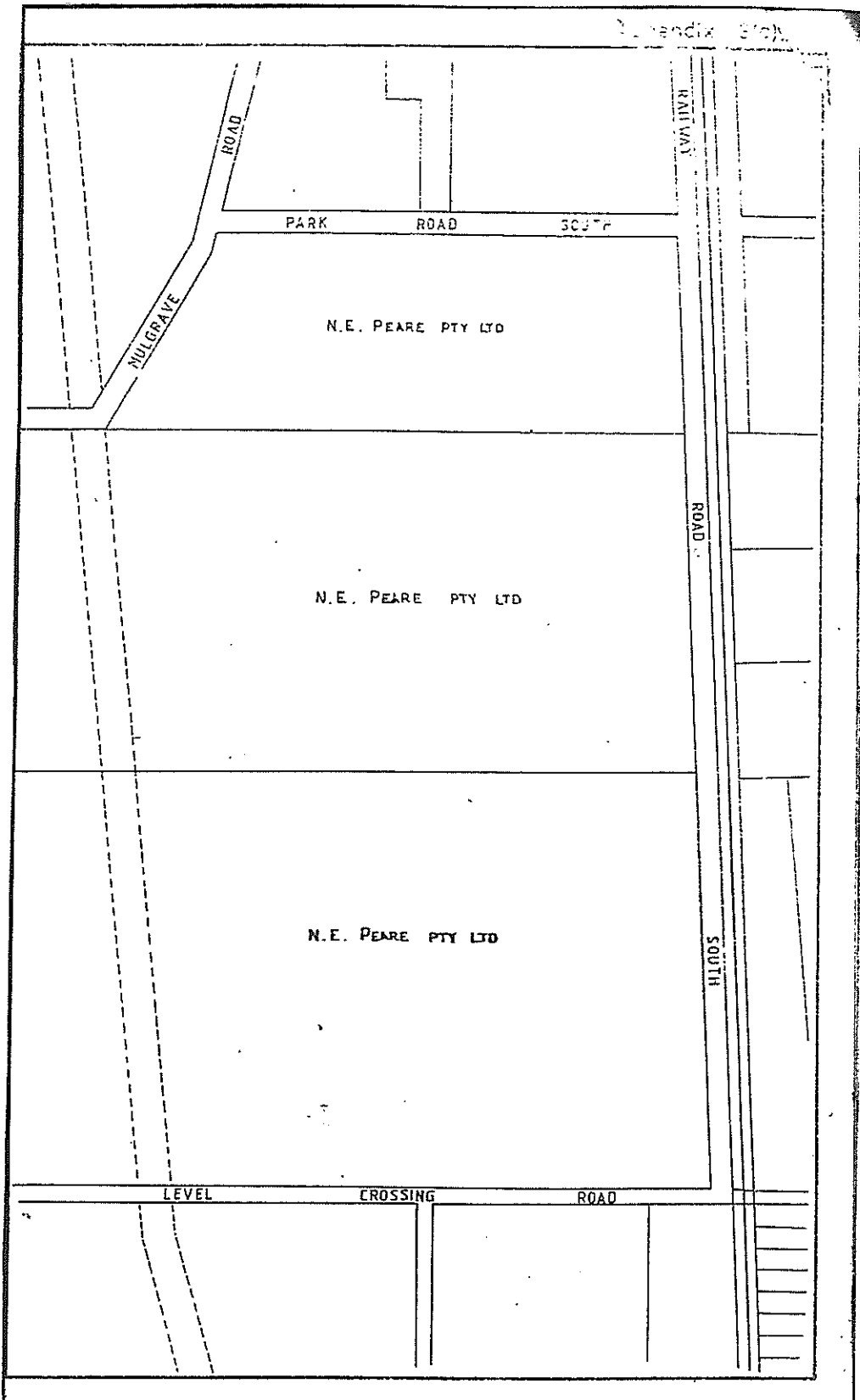

Land ownership survey for Hawkesbury City Council c1980

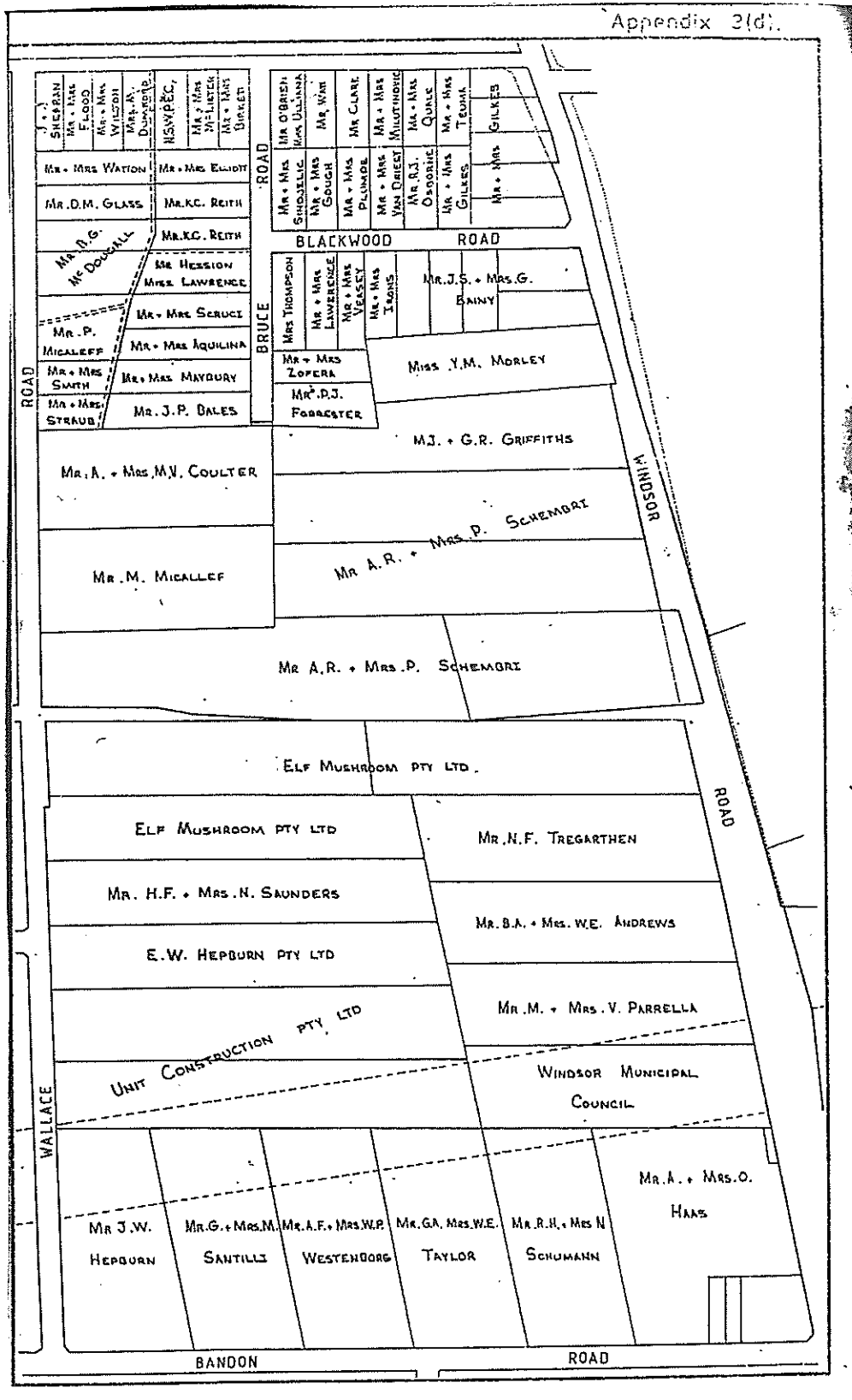

Land ownership survey for Hawkesbury City Council c1980

W

HAWKESBURY SHIRE LIBRARY



000 15764 9

ENVIRONMENTAL STUDY VINEYARD

Prepared by

TOWN PLANNING DEPARTMENT,
WINDSOR MUNICIPAL COUNCIL





WINDSOR MUNICIPAL COUNCIL	REC'D	REF. BOX R307.14 (2)
31	COX DEN	
5/11/80	A-W	

R.A.Cole
Chief Town Planner.

August, 1980.

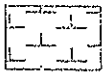
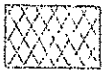
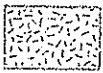
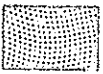
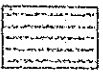
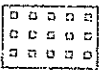
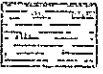
EXISTING LAND USES Circa 1980

LEGEND

MUSHROOM GROWING FARM	
POULTRY FARM	
DOG KENNELS	
GRAZING	
INDUSTRIAL COMPLEX	
OPEN SPACE	
DAM	
GENERAL STORE	
RESTAURANT	
DWELLING	

SCALE - 1:4000



SCALE - 1:4000

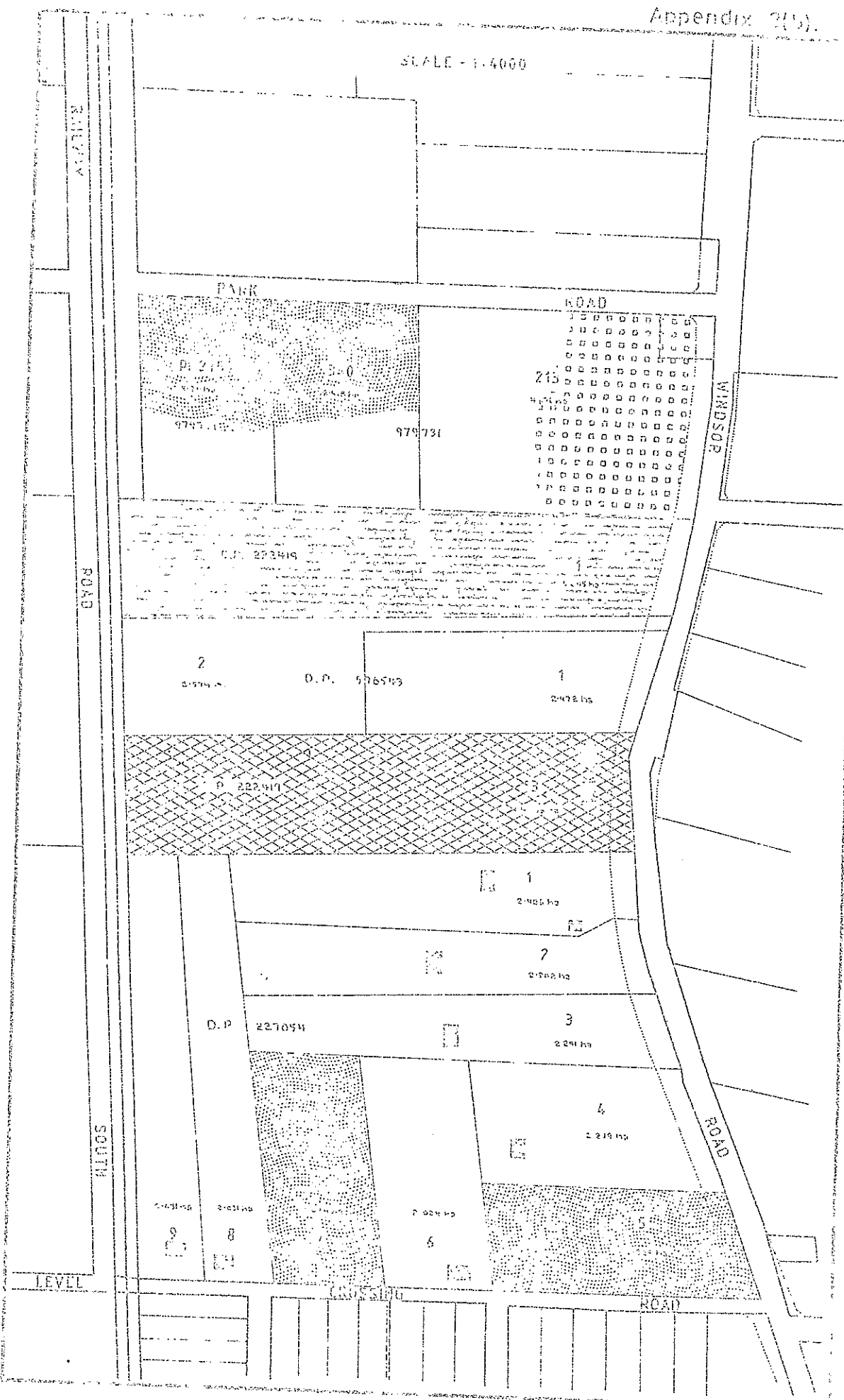

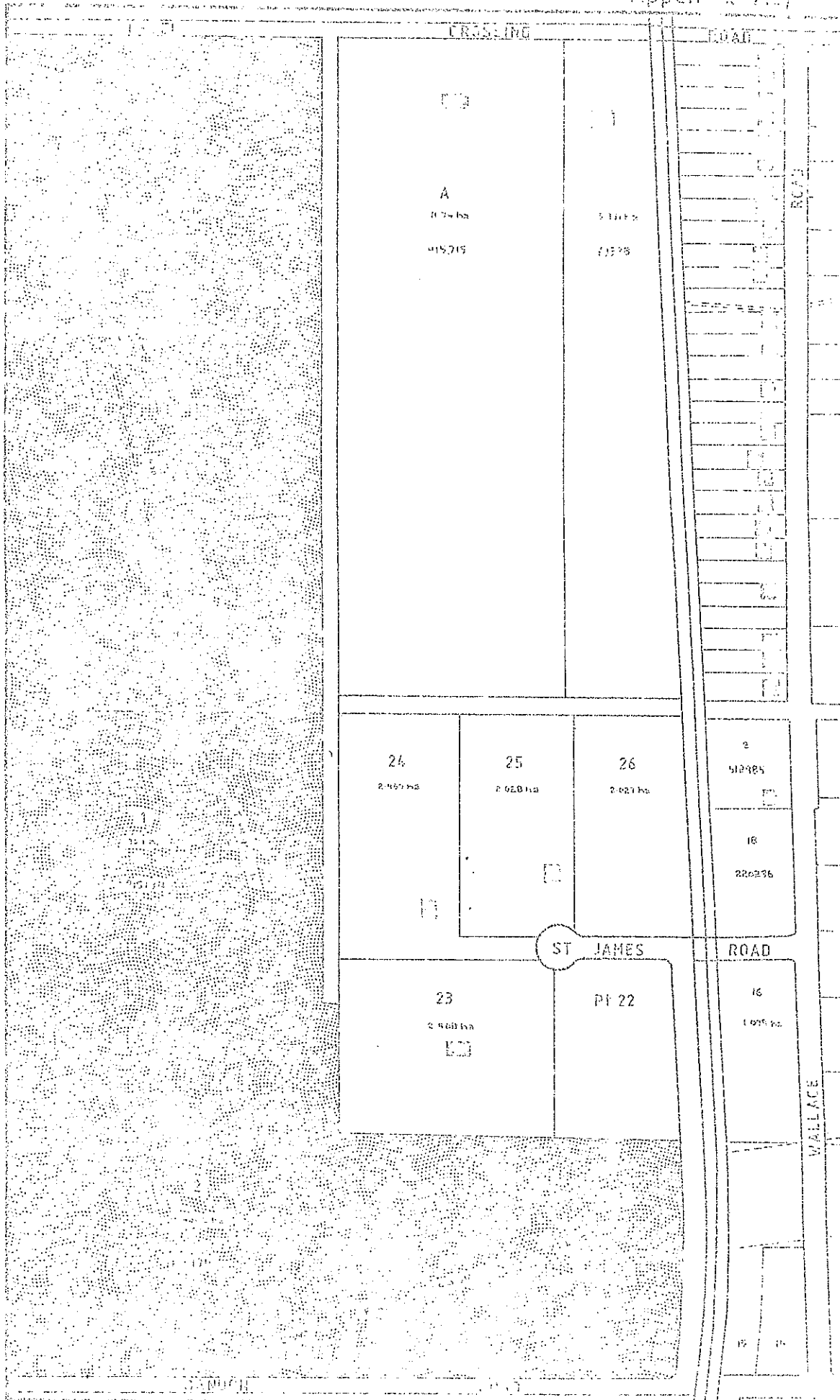

SCALE 1:1000

